

SOLID™



- **Design and Application**
- **Unpacking and Aftercare**
- **Installation**
- **Positioning**
- **Electrical connection**
- **Optional accessories**
- **Specifications**

Congratulations and thank you for choosing SOLID.

This small, versatile and powerful monitor has been stylishly designed by Morten Warren for Rock SOLID Sound Inc., England. To ensure the maximum sound quality we teamed up with B&W Loudspeakers for the acoustical engineering of this high quality monitor speaker.

Design and Application

SOLID is a speaker with quite extraordinary versatility. Apart from its role in a conventional Hi-Fi system, it is ideally suited for use with drum machines or keyboards, and its magnetic shielding makes it an excellent television stereo monitor.

SOLID has been designed for use in any room in the house — with its multipurpose stand it can be suspended from walls and ceilings.

SOLID's gently curving exterior design minimises unwanted diffraction, and the fully moulded cabinet reduces troublesome internal cabinet resonances. B&W's renowned expertise has resulted in an exceptionally smooth-sounding unit giving remarkable stereo imaging.

Unpacking and Aftercare

The SOLID carton contains:

- One pair of SOLID loudspeakers
- One pair of SOLID multipurpose stands
- One pair of SOLID bass grilles
- One Allen key for tightening the stand

Dust accumulation on the drivers can be removed occasionally by lightly dusting with a very soft brush.

The packing carton protects the speakers from damage in transit, and should be retained. We recommend that speakers are always re-packed before being moved.

Installation

SOLID's integrated stand with rubber feet allows the unit to be placed on any surface without fear of scratching or damage. These rubber feet further serve to isolate unwanted vibration.

SOLID can be wall or ceiling mounted, using appropriate countersunk screws. Detach the unit from the stand using the Allen key to undo the three Allen screws and clamping ring at the back (Fig 1). Peel off the top side of the rubber feet to reveal the screw holes (Fig 2). Mark the mounting surface clearly and accurately. The unit must be secured firmly to a structural member; ceiling and wallboarding material will not be strong enough. With the stand mounted, replace the rubber feet to conceal the screw heads. With the speaker mounted and angled to the desired position, use the Allen key to tighten the unit.

(Please note: DO NOT force the movement — loosen Allen screws first).

When SOLID is attached to the wall or ceiling, we recommend a dedicated safety cable for extra safety in public places and where there may be small children. This safety cable is an optional extra and available from your local dealer.

Positioning

SOLID has been acoustically designed to give best results when placed near a wall or on a shelf. (We advise against placing them in the corners of a room, since this excites excessive natural resonances). For best quality sound the unit should be mounted with the tweeter at listening position ear level. With recommended wall mounting, the response is effectively maintained, down to 50 Hz.

Electrical connection

SOLID loudspeakers are suitable for amplifiers of 20 watts to 150 watts. Connect Red + to Red + on your amplifier, and Black - to Black -. Correct phasing of stereo loudspeakers is extremely important - loss of bass and poor stereo image will result if this connection is incorrect.

SOLID's remarkable sound quality for such a physically small unit results from its sensitivity at 90 dB for 2.83 volts, while bass reflex loading ensures that the response is maintained down to 70 Hz.

SOLID incorporates a protection device which turns down the input level when the safe power handling limit is reached. Under these conditions input should be reduced.

Optional accessories

The larger SOLID 'Array' stand holds up to four SOLID speakers at a time - this arrangement is especially effective for shops, bars, restaurants etc.

Specifications

Enclosure type: Vented bass enclosure with fourth order alignment

Frequency range: 75 Hz to 20 kHz +/- 3 dB

Sensitivity: 90 dB for 2.83 volts (1 watt into 8 ohms)

Impedance: Nominal 8 ohms

Power handling: Suitable for amplifiers of up to 150 watts into 8 ohms

Dimensions: Height 233 mm - Width 163 mm - Depth 150 mm

Rock SOLID Sounds Incorporated Ltd. reserve the right to amend details of their specifications in line with technical developments.

SOLID is a trademark of Rock SOLID Sounds Incorporated Ltd.

Rock SOLID Sounds Incorporated Ltd. is a member of the B&W group of companies.

Warning

While every precaution has been taken to ensure the mechanical soundness of the solid stand's fixing arrangements, Rock Solid Sounds Incorporated Ltd. accepts no responsibility for damage or injury caused by failure of either the stand, its fixings, or by neglecting to use the recommended safety cable.

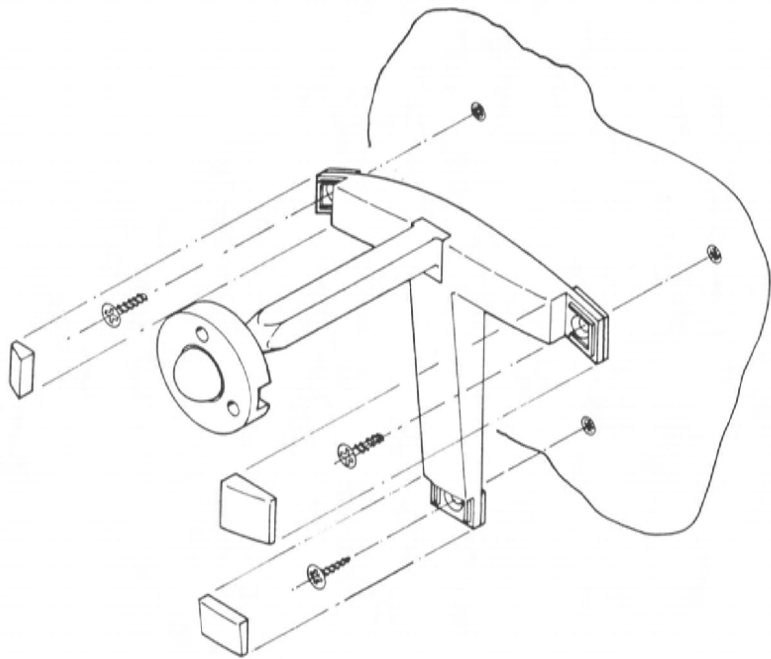

Fig 2

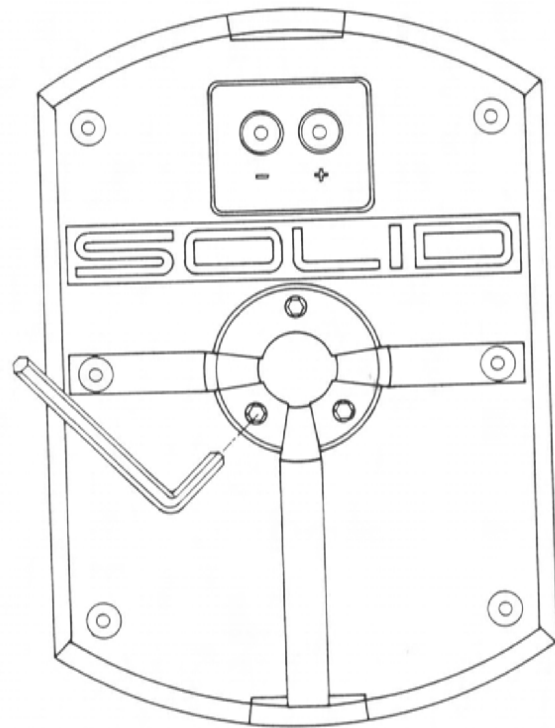

Fig 1

Rock Solid Sounds Inc. Ltd., Worthing, England